

1 1/8"-12 UNF HP Adapter		
Ordering Code	UHP Connection	Max. Pressure
6-834	9/16"-18 UNF (1/4 UHP)	5.000 bar

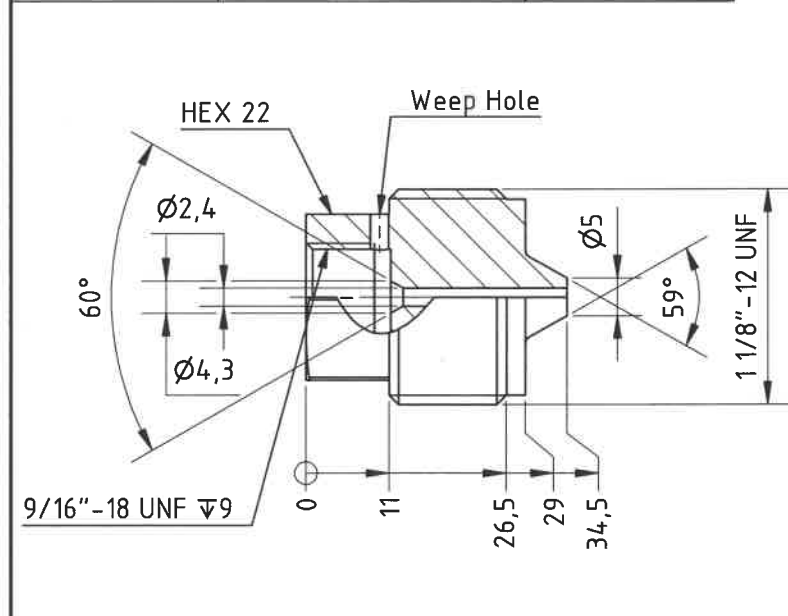

1 1/8"-12 UNF HP Adapter		
Ordering Code	HP Connection	Max. Pressure
6-835	1/4" BSPP	3.000 bar

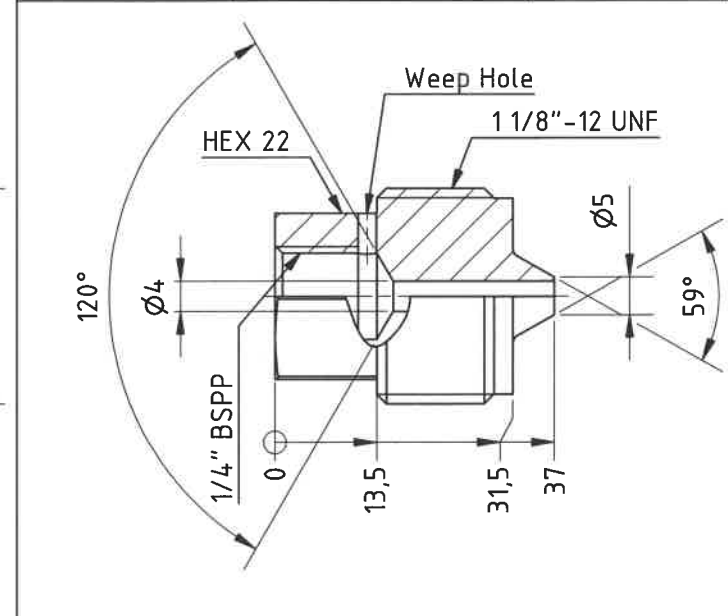

1 1/8"-12 UNF HP Adapter		
Ordering Code	UHP Connection	Max. Pressure
6-837	5/8"-18 UNF (1/4 UHP)	5.000 bar

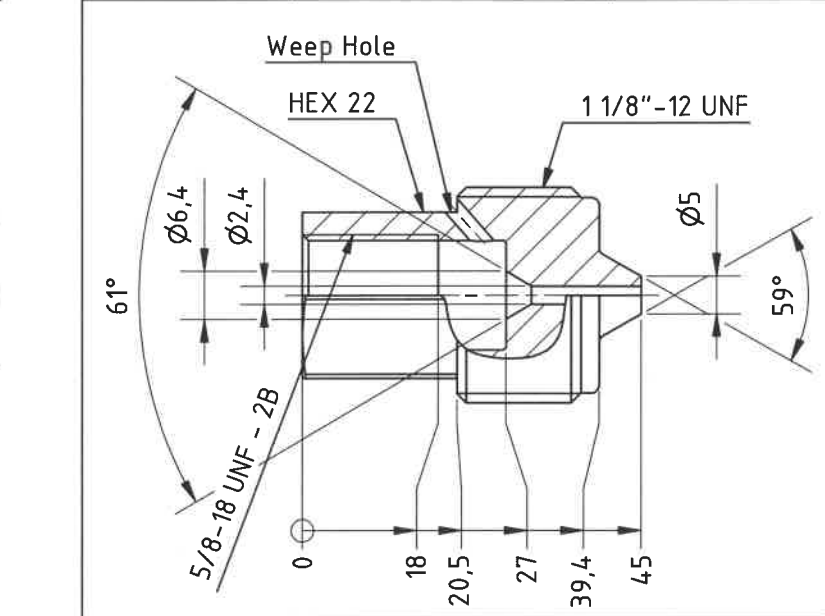

1 1/8"-12 UNF HP Adapter		
Ordering Code	UHP Connection	Max. Pressure
6-833	1 1/8"-12 UNF	5.000 bar

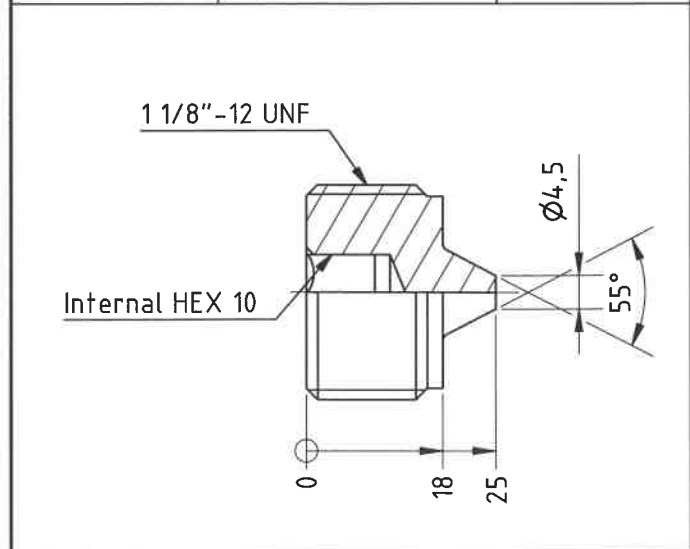

Tightening Torque	
M42x1,5	1 1/8"-12 UNF
350 Nm	100 Nm

Material		Issue	Material Code No.
Changes	Date	Name	Finish
Adapter 6-834 added	08-03-2017	L.H.	
Adapter 6-835 added	28-09-2017	L.H.	Break all edges
Adapter 6-836 & 6-837 added	26-10-2020	L.H.	Hardening depth
6-832 & 6-836: HP seal groove added	24-02-2021	L.H.	
Tightening torque added	15-04-2024	L.H.	HV
Designer	Leif Hansen	Scale 1:1	
Approved by		Format A3	
Date	09-12-2016	HC6H (U)HP Adapter	
		Connection Possibilities	
		Assembly Drawing	
<small>Confidential: Property of miniBOOSTER HYDRAULICS A/S Denmark Not to be handed over to, copied or used by third party.</small>			